

Inkscape: Penguin

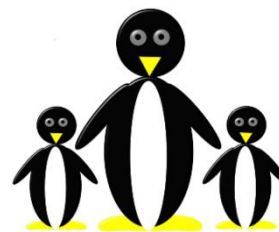







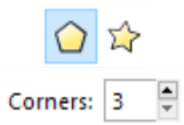

REMEMBER... press **Ctrl Z** if you need to **UNDO**.

ENLARGE the image when drawing small, detailed shapes.

Shift-Ctrl-F displays the colour properties panel.

<p>Select the Oval tool (E)</p> <p>Drag the mouse to draw an ellipse for the body.</p> <p>Fill colour: Black.</p>	
<p>Click outside your black ellipse to deselect it.</p> <p>Draw another ellipse inside the black ellipse.</p> <p>Fill colour: White.</p> <p>Use the Select tool to position and size the white ellipse</p>	
<p>Click the Circle tool (F5).</p> <p>Fill colour: Black.</p> <p>Whilst holding CTRL+ALT, click and drag to draw a perfect circle for the head.</p>	
<p>Click outside your black ellipse to deselect it.</p> <p>Fill colour: LIGHT GREY</p> <p>Draw a circle for the eye.</p> <p>Draw a smaller BLACK circle inside for the pupil.</p>	
<p>Click the Select tool and draw round the eye and the pupil so that both circles are selected.</p> <p>MENU: Object - Group (Ctrl G)</p>	
<p>Use COPY and PASTE to create another eye.</p> <p>Click the Select tool and position them.</p>	
<p>Fill colour: yellow.</p> <p>Draw an ellipse for a foot.</p>	
<p>Select the foot.</p> <p>MENU: Path - Object to Path (CTRL+SHIFT+C)</p>	
<p>Click the Path Node tool (F2)</p>	
<p>Click and drag the bottom node to flatten the foot.</p>	

Copy and paste the foot to create a second foot. Click Select (F1) to position and size the feet.	
Fill colour: yellow. Click the Create stars and polygons tool (*).	
Using the toolbar, make sure 'polygon' is selected and type in '3' into the 'corners' box.	
Click and drag to draw the beak - as you create it, you can rotate it.	
Fill colour: black. Click the Ellipse tool (F5). Draw a wing at the side of the body.	
Click the Select tool (F1). Click twice on the wing so the arrows change to curved arrows. Click and DRAG the small white + symbol in the middle of the shape to the TOP MIDDLE - this is the <i>rotation point</i> .	
Use the TOP RIGHT rotation arrow to rotate the wing.	
Click the Select tool to reposition the wing on to the body.	
Copy and paste the wing. MENU: Object - Flip horizontal (H) and reposition the wing.	